



MODELS INCLUDED:

- 90N30A NAT.
- 90N50A NAT.
- 90N65A NAT.

GAS FLOOR FURNACE LIST PRICES

Prices and specifications subject to change without notice. All prices are F.O.B. factory. Specify model number when ordering parts.

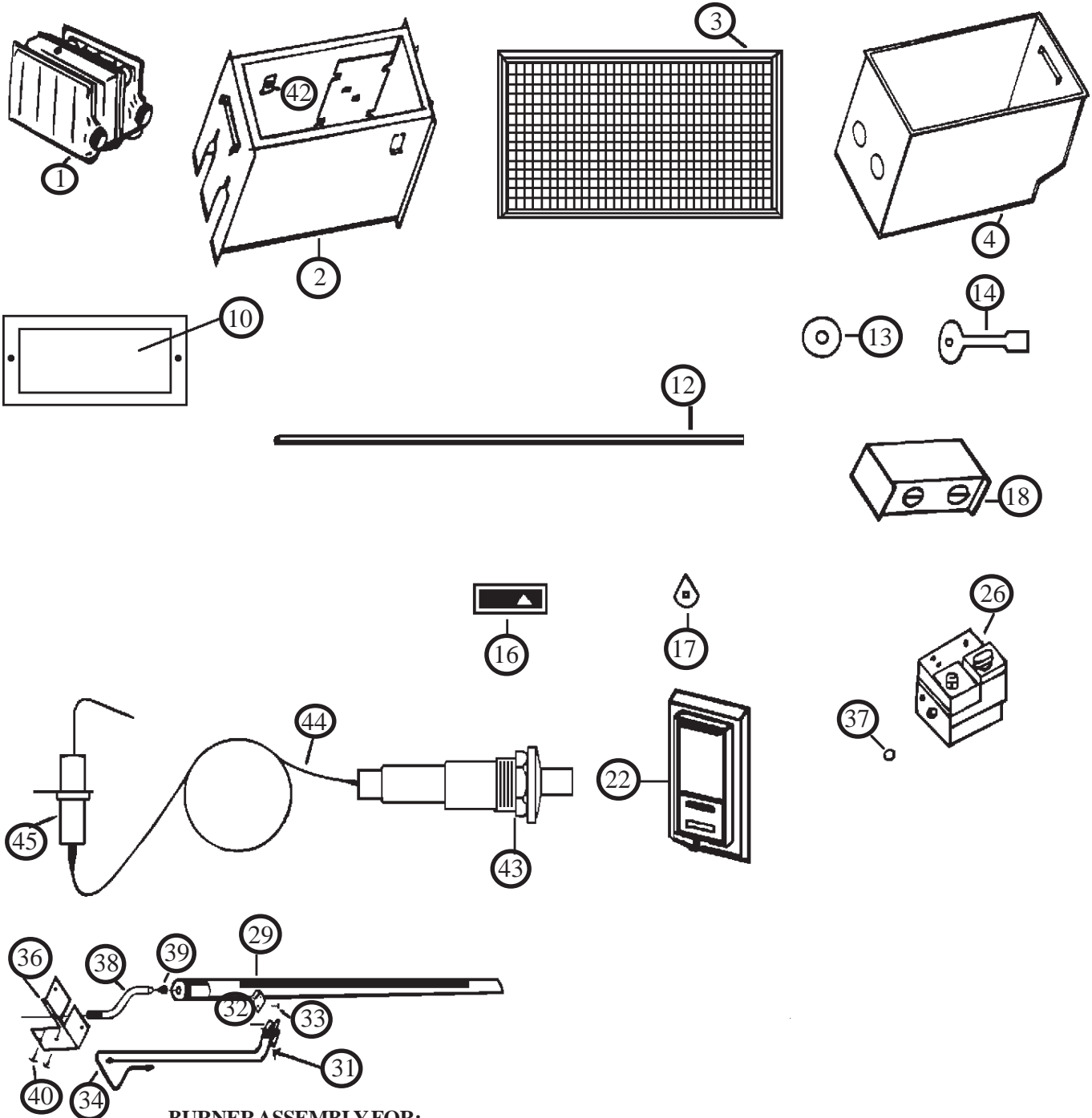

BURNER ASSEMBLY FOR:

- 90N30A
- 90N50A
- 90N65A

ATTN: Contractors and Service Technicians, we only sell parts through our wholesalers, but the prices listed are for your convenience. For prompt parts service, contact the wholesaler from which you purchased your Cozy heater. **NOTE:** Parts & schematic drawings on current models are shown at www.cozyheaters.com.

JUNE 2015

HOW TO PROPERLY ORDER PARTS: In addition to part description and part number, please give model number, serial number, and type of gas used. This information can be found on the rating plate that is attached to heater.

MODEL NUMBER	NAT.	90N30A		90N50A		90N65A	
		REF. NO.	PART NO.	LIST PRICE	PART NO.	LIST PRICE	PART NO.
Heat Exchanger with Gasket	1	23074		24099		24499	
Gasket, Heat Exchanger	N/A	74530		74530		74532	
Liner, Complete Assembly	2	23001		23980		24380	
Grille, Floor	3	23145		24175		24475	
Casing, Complete Assembly	4	23040		24002		24402	
Sight Glass Assembly (gasket not included)	10	23150		23150		23150	
Valve Rod	12	24035		24035		24035	
Washer, Valve Rod	13	24044		24044		24044	
Key, Furnace	14	74205		74205		74205	
Instruction Plate, Lighting	16	91256		91256		91256	
Valve Rod Indicator Plate	17	24045		24045		24045	
Draft Hood Assembly w/Gasket	18	23200		24075		24477	
Draft Hood Gasket w/Screws	19	23225		24077		24077	
Thermostat, Millivolt	22	74592		74592		74592	
Wire, Thermostat 20'	23	74518		74518		74518	
Staples, Thermostat Wire	24	74209		74209		74209	
Valve, VS821A1061 Nat.W/74414 Bushing	26 & 37	74315		74315		74315	
Disappearing Bushing 1/4x3/8	37	74414		74414		74414	
L.P. Conversion Kit	N/A	49200		49210		49220	
Burner w/Pilot Brkt. & Air Adj.	29	74401		74401		74402	
Pilot Generator, Q313A1014 M.V. 23"	31	70098		70098		70098	
Pilot Burner w/Orifice Q350A1271 N.	32	74410		74410		74410	
Pilot Burner w/Orifice Q350A1589 LP	32	74415		74415		74415	
Mounting Screws, Pilot (2)	33	50107		50107		50107	
Pilot Tubing w/Fittings	34	74452		74452		74452	
Burner Support, Front	36	24036		24036		24036	
Burner Support, Rear	N/A	24430		24430		24430	
Manifold	38	74416		74416		74416	
Burner Orifice, Natural Gas	39	74390		74406		74407	
Burner Orifice, L.P. Gas	39	74609		74606		74607	
Warning Flag	41	24068		24068		24068	
Limit Control 60T11	42	*74306		*74307		*74308	
Wiring Harness	N/A	74320		74321		74322	
Piezo Ignitor	43	80016		80016		80016	
Ignitor Wire	44	74351		74351		74351	
Electrode	45	74350		74350		74350	
Bottom Burner Cover	N/A	24039		24039		24431	
* = Requires 2							

ATTN: Contractors and Service Technicians, we only sell parts through our wholesalers, but the prices listed above are for your convenience. For prompt parts service, contact the wholesaler from which you purchased your Cozy heater. **NOTE:** Parts & schematic drawings on current models are shown at www.cozyheaters.com.

Prices and specifications subject to change without notice. All prices are F.O.B. factory.

P/N 74521

JUNE 2015